



**Assessment Notice**

[2022 Assessment Notice \(PDF\)](#)

**Summary**

Parcel Number 12315000  
 Location Address 321 MICHIGAN ST  
 LEXINGTON KY 40508  
 Tax District District 01  
 Tax Rate 1.2727  
 Acres 0.0784  
 Legal Description N-189 FOREST HILL ADDITION LOT P 1&2  
 Property Class R - RESIDENTIAL  
 PVA Neighborhood 132 - FORREST HILL LAND CO & DOUGLAS HEIGHTS  
 Land Use Code (510) R - SINGLE FAMILY DWELLING, PLATTED LOT  
 USA/RSA Map 16  
 Map Block 061  
 Lot P 1&2  
 Subdivision FOREST HILL ADDITION  
 Cabinet/Slide ND-189  
 ND-1 Zone  
 Overlay  
 PDR  
 Map Scale 200  
 Block  
 LFUCG Zoning R-2 - TWO-FAMILY RESIDENTIAL  
 Deeded SqFt 3,420  
 Frontage / Out of 38 /



**Owner**

ROGERS GERALD  
 321 MICHIGAN ST  
 LEXINGTON KY 40508 1136  
 January 1, 2022 Owner  
 ROGERS GERALD

**Residential Improvement Information**

Card	1	Full Bath/Half Bath	1/0
Stories	1	Attic	NONE
Exterior Wall	FRAME	Additional Fixtures	3
Style	Single Family	Heating System	HOT AIR
Year Built	1920	Heat	NON CENTRAL
Res Sq Ft	816	Total Fixtures	6
Basement	NONE	Masonry Fireplaces	2
Total Bsmt Sqft		Heating Fuel Type	GAS
Finished Bsmt Sqft	0	Pre Fab Fireplace	0
Garage Sqft		Split Level/Foyer	
Garage Type		Miscellaneous Feature	
Total Rooms	0	Miscellaneous Feature 2	
Bedrooms	0		

**Accessory Information**

Card 1

Description	Year Built	Size	Area	Grade
EQUIPMENT SHED	1950	12 x 10	120	

**Comparable Sales List**

Show Property Photos

Parcel ID	Address
<a href="#">11076100</a>	453 BRADLEY CT
<a href="#">17222100</a>	412 DOUGLAS AVE
<a href="#">12488900</a>	828 CHARLES AVE
<a href="#">12841300</a>	691 GEORGETOWN ST
<a href="#">10461100</a>	551 GEORGETOWN ST

**Sales**

Sale Date	Sale Price	Deed Book	Deed Page	Sales Validity	Owner	Previous Owner	Recording
5/1/1989	\$0	1510	330	ARMS LENGTH TRANSACTION	ROGERS GERALD	GARRISON EMMA	1510 330

**Valuation**

	2022	2021	2020	2019
Fair Cash Value	\$40,000	\$40,000	\$24,200	\$24,200
Agricultural Value Land	\$0	\$0	\$0	\$0
Agricultural Value Total	\$0	\$0	\$0	\$0
Exempt	\$40,000	\$40,000	\$24,200	\$24,200
Taxable Value	\$0	\$0	\$0	\$0

**Sketches**

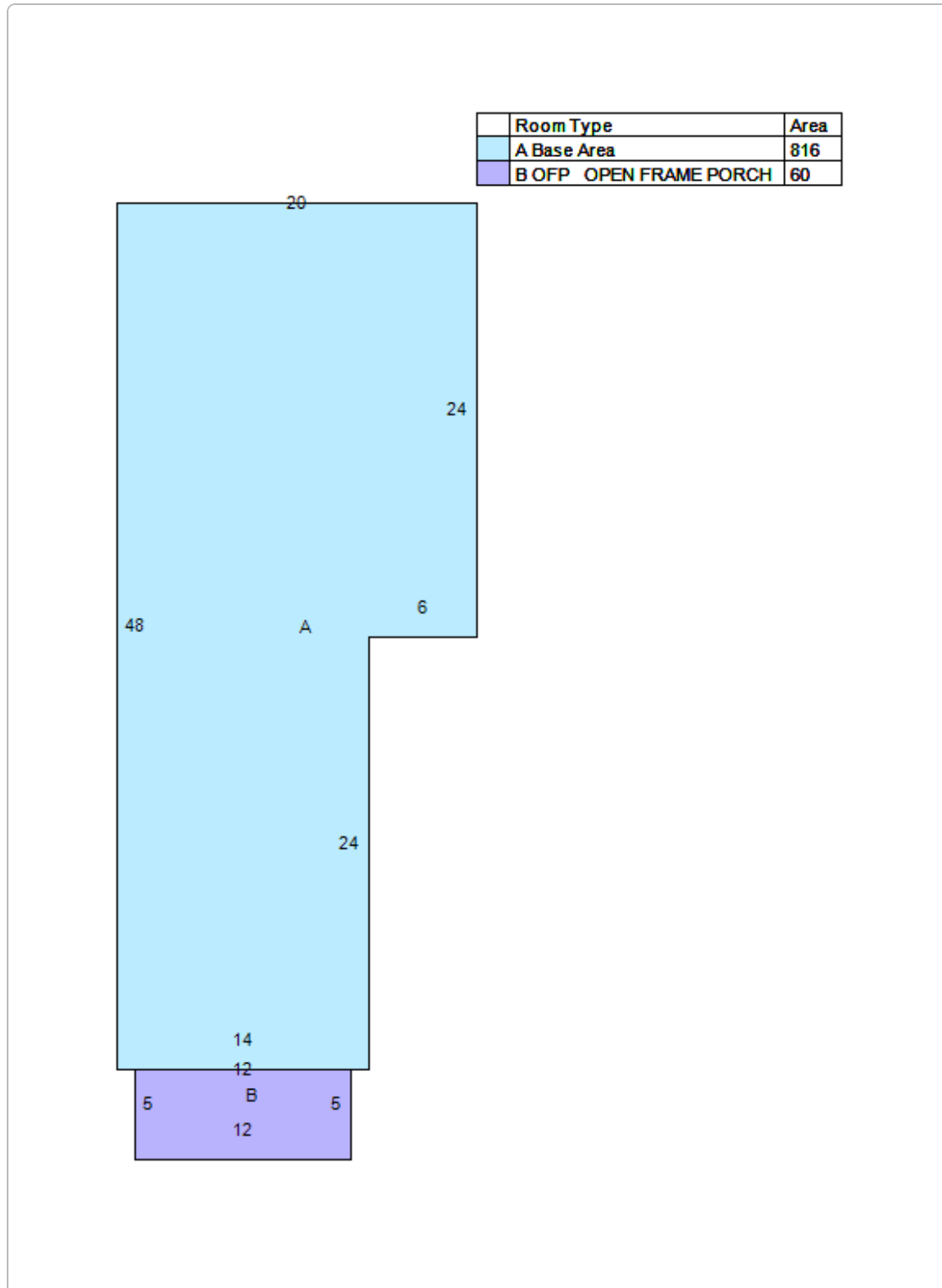

**Photos**



**No data available for the following modules:** Commercial Improvement Information, .

The Fayette County Property Valuation Administrator's Office makes every effort to produce the most accurate information possible. No warranties, expressed or implied, are provided for the data herein, its use or interpretation.

[User Privacy Policy](#)  
[GDPR Privacy Notice](#)

[Last Data Upload: 4/27/2022, 8:40:00 AM](#)

Developed by  
 Schneider  
GEOSPATIAL

Version 2.3.191